

Option D

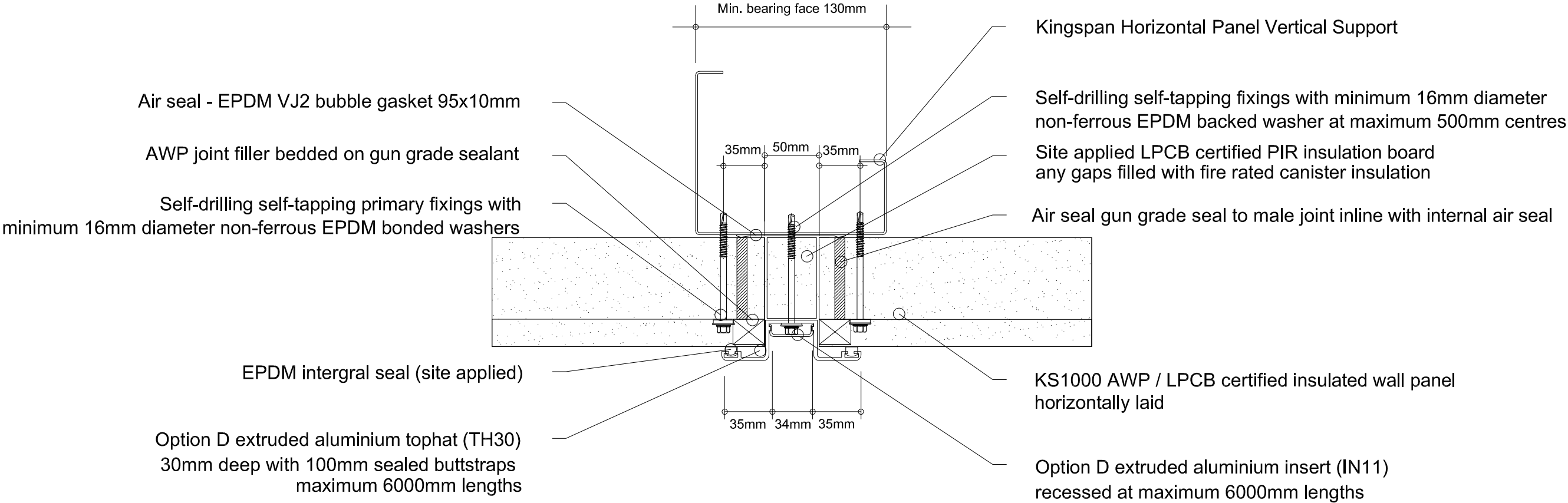

Note for KS1000WV Profile: 9x6mm PVC foam tape should be used instead of the noted 4mm diameter butyl rubber sealant between the face of the panel and any external flashings including vertical tophat flashings.

Note: Seconday steelwork should be continuous, however if there is any gaps between the vertical supports which are above 20mm a flashing plate should be introduced to brige the gap - refer to Kingspan Envirocare Update 49

Note: Kingspan aluminium tophats are supplied mill finish as standard or can be supplied PPC to BS or RAL colours

Notes:

Rev	Description	Chkd	Date



**Insulated Roof & Wall Panels**

**envirocare**  
TECHNICAL SERVICES

**Kingspan Limited**  
Greenfield Business Park No. 2, Greenfield,  
Holywell, Flintshire, CH8 7GJ, UK  
www.kingspanpanels.co.uk  
t: 0800 587 0090

Carrickmacross Road,  
Kingscourt, Co.Cavan, Ireland  
www.kingspanpanels.ie  
t: 00353 42 96 98529

Client

Project

Drawing

KS1000 AWP Hz  
Option D Vert Joint

Status

Drawn by	Checked by	Date
RL	JP	11/02/15

Drawing Number	Revision
AWPHz15025	

This drawing is the property of Kingspan and may not be reproduced in any way without written consent from Kingspan.