

Factory applied anti-condensation tape

Snap-on cover cap with  
factory applied foam tape

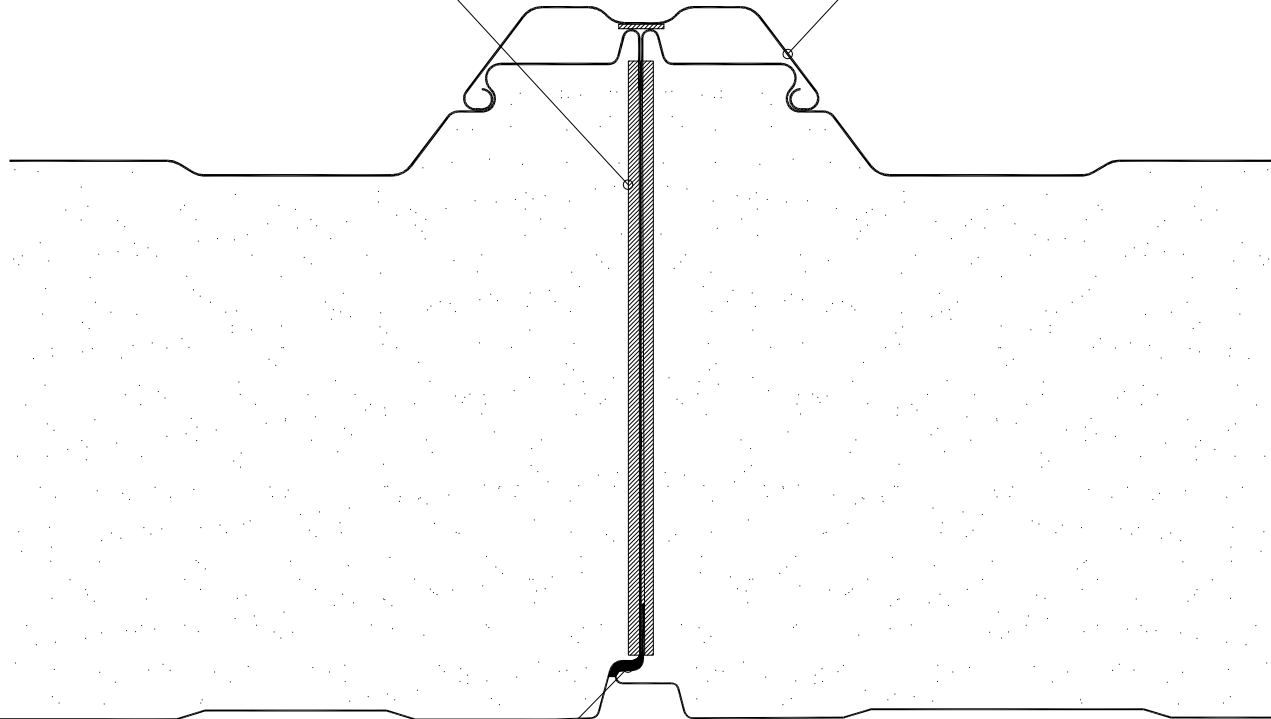

6mm bead of gun grade sealant  
Vapour seal when required (site applied)

Self-drilling self-tapping primary fixings with minimum 16mm  
diameter non-ferrous EPDM backed washer

End lap tail stitching screws with minimum 19mm diameter non  
ferrous EPDM backed washer, 5 number across panel width

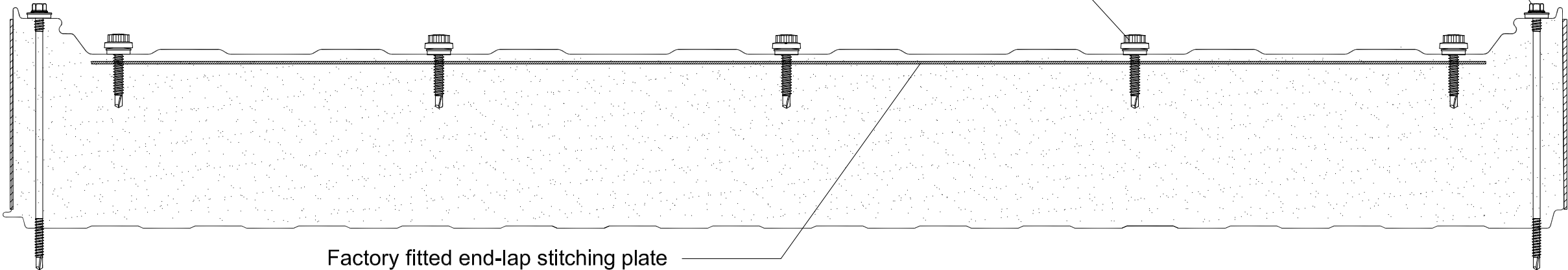

Factory fitted end-lap stitching plate

Notes:

Rev	Description	Chkd	Date



Insulated Roof  
& Wall Panels

envirocare<sup>®</sup>  
TECHNICAL SERVICES

Kingspan Limited  
Greenfield Business Park No. 2, Greenfield,  
Holywell, Flintshire, CH8 7GJ, UK  
www.kingspanpanels.co.uk  
t: 0800 587 0090

Carrickmacross Road,  
Kingscourt, Co.Cavan, Ireland  
www.kingspanpanels.ie  
t: 00353 42 96 98529

Client

Project

Drawing

KS1000 LP  
Fixing Location

Status

Drawn by JP	Checked by AP	Date 02/01/15
----------------	------------------	------------------

Drawing Number LP15002	Revision
---------------------------	----------

This drawing is the property of Kingspan and  
may not be reproduced in any way without  
written consent from Kingspan.